



**33-7**  
**36-7**



**35-7**  
**38-7**



**34-7**  
**37-7**

REFERENCIA reference	33-7	34-7	35-7	36-7	37-7	38-7
CILINDRO FIJO fixed cylinder	X	X	X			
CILINDRO GRADUABLE adjustable cylinder				X	X	X

Ref. 33 y ref. 36: Dos vueltas de pestillo

Ref. 34 y ref. 37: Dos vueltas de pestillo, picaporte accionado con pomo

Ref. 35 y ref. 38: Dos vueltas de pestillo, picaporte accionado con manilla  
Cuadradillo 8mm

Modelo no reversible: mano derecha o izquierda

3 llaves de alpaca ref. n° 2

Cilindro fijo de 52mm ó Cilindro graduable para puertas de 35 a 80mm

Acabado: **PINTADO DORADO**

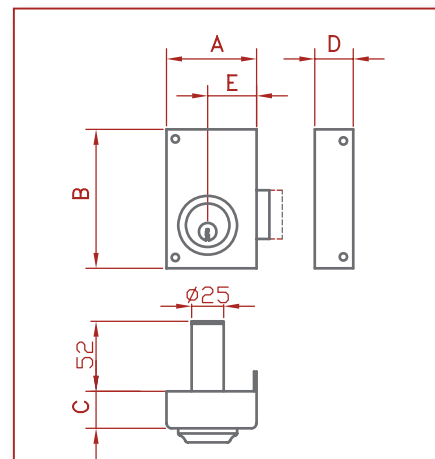

	A	B	C	D	E
<b>33 / 34 / 35</b> <b>36 / 37 / 38</b>	70	110	28	30	40

Ref. 33 and 36: Two turns bolt

Ref. 34 and 37: Two turns bolt, knob-operated latch

Ref. 35 and 38: Two turns bolt, handle-operated latch, square bar 8mm

Non-reversible model: left or right hand

3 silver nickel keys ref n° 2

Fixed cylinder with size 52mm or adjustable cylinder for door sizes

35 to 80mm

Finish: **GOLD PAINT**