



# fischer DUOBLADE

The self-drilling plasterboard plug  
for fast and easy installation



# fischer DUOBLADE

## The self-drilling plasterboard plug for fast and easy installation

# fischer DUOBLADE

## Installation, recommendation and application

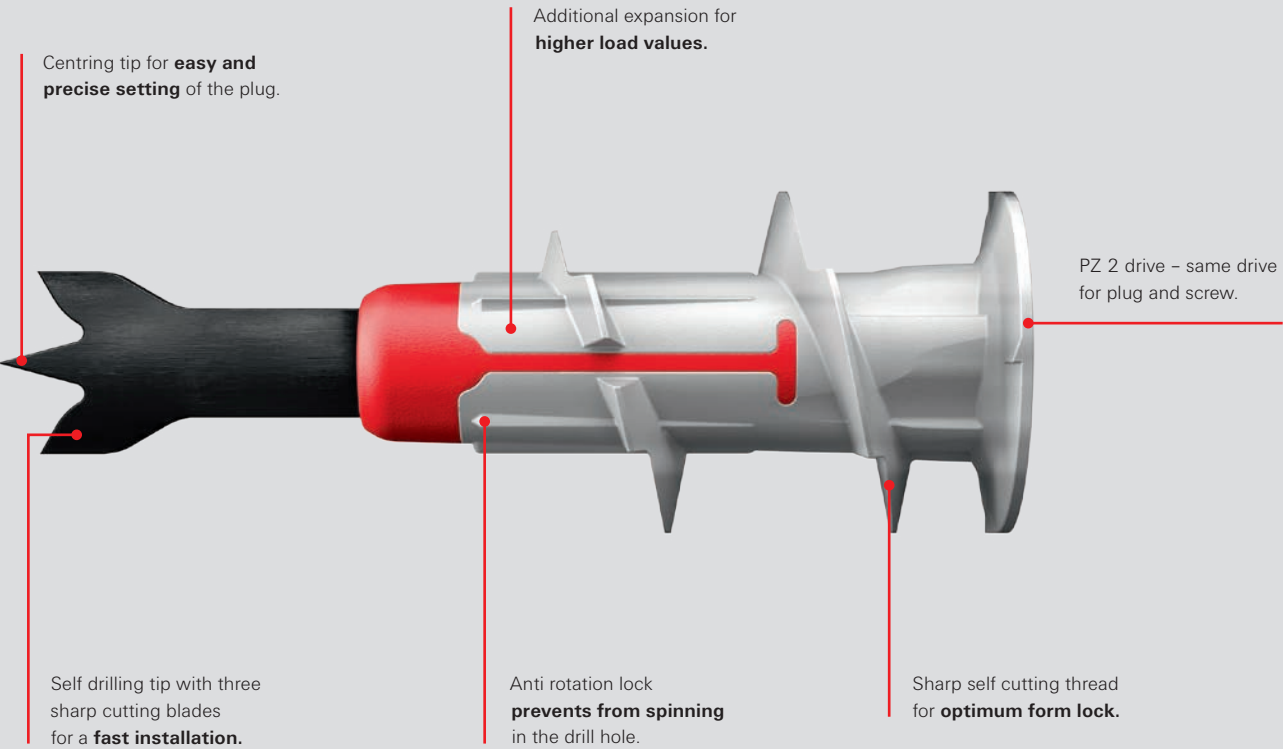

### Function

- The fischer DUOBLADE is suitable for pre-positioned installation.
- The metal tip for better heat-resistant and cutting characteristics. Especially in double-layered plasterboard.
- The fischer DUOBLADE can be used with wood, metal and chipboard screws of Ø4.0 to Ø5.0 mm.

Your advantages at a glance

- An innovative product of the fischer DUO-Line with intelligent combinations for more power and more intelligence.
- The self-drilling fischer DUOBLADE allows fast and easy installation in gypsum plasterboard and gypsum fibreboard.
- The black metal tip guarantees simple and safe installation.
- High torque when anchor is installed for the feelgood-factor and an optimum feeling when setting.

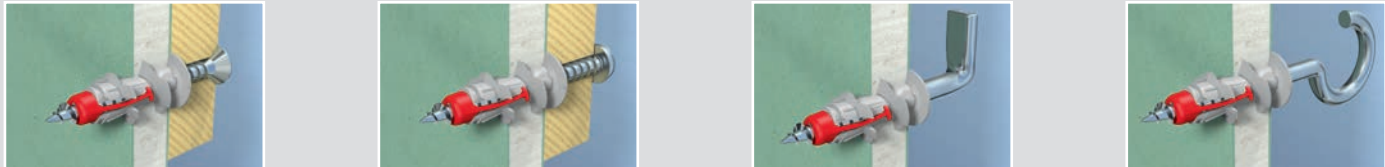

### Installation in panel building materials

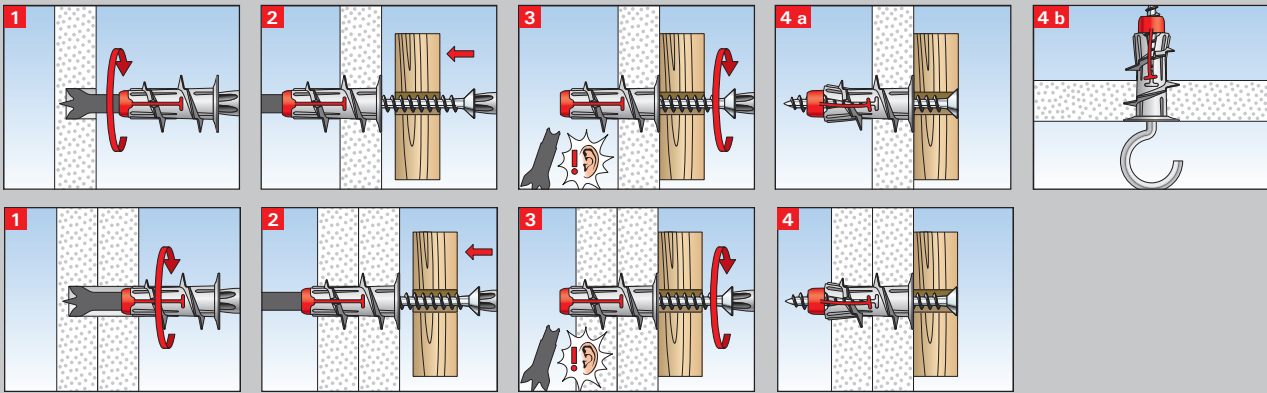

### Recommendation

- Suitable for all panel building materials e. g.



gypsum plasterboards

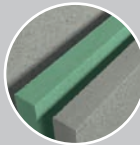

gypsum fibreboards



lightweight cement board

### Test mark / Product family



### Applications



Smoke detectors



Mirrors



Curtain rods



Blinds



Lamps



Pictures



# fischer DUOBLADE

## Assortment and Loads

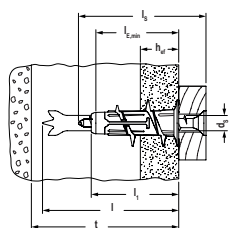
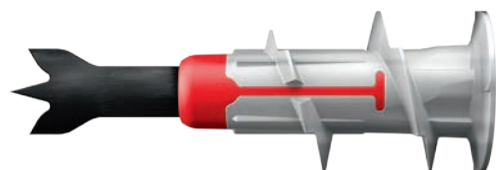

| fischer DUOBLADE |          |  |               |                                    |                    |                          |                                 |            |
|------------------|----------|--|---------------|------------------------------------|--------------------|--------------------------|---------------------------------|------------|
|                  | Art.-No. | Min. thickness<br>to first supporting<br>layer | Anchor length | Anchor length<br>without drill tip | Anchorage<br>depth | Min. bolt<br>penetration | Screw                           | Sales unit |
|                  |          | t  | l             | l <sub>1</sub>                     | h <sub>el</sub>    | l <sub>E,min</sub>       | d <sub>s</sub> x l <sub>s</sub> |            |
| Item             |          | [mm]   | [mm]          | [mm]                               | [mm]               | [mm]                     | [mm]                            | [pcs]      |
| DUOBLADE         | 545675   | 50   | 44            | 29                                 | 9.5                | 28                       | 4 - 5                           | 50         |
| DUOBLADE S       | 545676   | 50   | 44            | 29                                 | 9.5                | 28                       | 4.5 x 40                        | 25         |
| DUOBLADE K NV    | 545683   | 50   | 44            | 29                                 | 9.5                | 28                       | 4 - 5                           | 10         |
| DUOBLADE S K NV  | 545684   | 50   | 44            | 29                                 | 9.5                | 28                       | 4.5 x 40                        | 6          |
| DUOBLADE WH K NV | 545685   | 50   | 44            | 29                                 | 9.5                | 28                       | 4.2 x 40                        | 6          |
| DUOBLADE RH K NV | 545686   | 50   | 44            | 29                                 | 9.5                | 28                       | 4.0 x 46                        | 6          |

### Plasterboard plug DUOBLADE

Highest recommended loads<sup>1)</sup> for a single anchor.  
The given loads are valid for chipboard screws with the specified diameter.

|  |             |      | fischer DUOBLADE |
|--|-------------|------|------------------|
| Chipboard screw  |             | [mm] | 4.0 – 5.0        |
| Recommended loads in the respective base material F <sub>empl</sub> 2) |             |      |                  |
| Gypsum plasterboard  | 9,5 mm      | [kN] | 0.08             |
| Gypsum plasterboard  | 12,5 mm     | [kN] | 0.10             |
| Gypsum plasterboard GKFI <sub>Typ: DFH2IR</sub>                        | 12,5 mm     | [kN] | 0.18             |
| Gypsum plasterboard  | 2 x 12,5 mm | [kN] | 0.20             |
| Lightweight cement board   | 12,5 mm     | [kN] | 0.08             |
| Gypsum fibreboard  | 12,5 mm     | [kN] | 0.34             |

<sup>1)</sup> Required safety factors are considered.  
<sup>2)</sup> Valid for tensile load, shear load and oblique load under any angle.

More power.  
More intelligence.



The innovative  
product line with

- More function
- More performance
- More security



# fischer FIXPERIENCE

## The design and information software suite



- The modular design program includes engineering software and application modules.
- The software is based on international design standards (ETAG 001 and EC2, such as EC1, EC3 and EC5), including the national application documents. All common force and measurement units are available.
- Incorrect input will be recognized and the software gives tips to get a correct result. This ensures a safe and reliable design every time.
- The graphical display can easily be rotated through 360°, panned, tilted or zoomed as required.
- The 3D display gives a detailed and realistic image.
- The "live update" feature helps to keep the program up to date ensuring you are always working with the latest version.
- Free download and updates at [www.fischer.de/fixperience-en](http://www.fischer.de/fixperience-en)

## Our service to you



We are available to you at any time as a reliable partner to offer technical support and advice:

- Our products range from chemical resin systems to steel anchors through to nylon anchors.
- Competence and innovation through own research, development and production.
- Global presence and active sales service in over 100 countries.
- Qualified technical consulting for economical and compliant fastening solutions. Also on-site at the construction site if requested.
- Training sessions, some with accreditation, at your premises or at the fischer ACADEMY.
- Design and construction software for demanding applications.

## This is what fischer stands for



FIXING SYSTEMS



AUTOMOTIVE SYSTEMS



FISCHERTECHNIK



CONSULTING



LNT AUTOMATION

See the extensive main catalogue or visit our website at [www.fischer-international.com](http://www.fischer-international.com) for information about the complete fischer range